

FCC WARNING:

This device complies with part 15 of the FCC Rules. Operation is subject to the following two conditions: (1) this device may not cause harmful interference, and (2) this device must accept any interference received, including interference that may cause undesired operation.

Any changes or modifications not expressly approved by the party responsible for compliance could void the user's authority to operate the equipment.

NOTE: This equipment has been tested and found to comply with the limits for a Class A digital device, pursuant to part 15 of the FCC Rules. These limits are designed to provide reasonable protection against harmful interference when the equipment is operated in a commercial environment. This equipment generates, uses, and can radiate radio frequency energy and, if not installed and used in accordance with the instruction manual, may cause harmful interference to radio communications. Operation of this equipment in a residential area is likely to cause harmful interference in which case the user will be required to correct the interference at his own expense.

- Reorient or relocate the receiving antenna.
- Increase the separation between the equipment and receiver.
- Connect the equipment into an outlet on a circuit different from that to which the receiver is connected.
- Consult the dealer or an experienced radio/TV technician for help.

To maintain compliance with FCC's RF Exposure guidelines, This equipment should be installed and operated with minimum distance between 20cm the radiator your body: Use only the supplied antenna.

WARNING:

This Equipment is not suitable for use in locations where children are likely to be present. The product needs to be reliably earthing after being powered on.

HPRT

Quick Start Guide

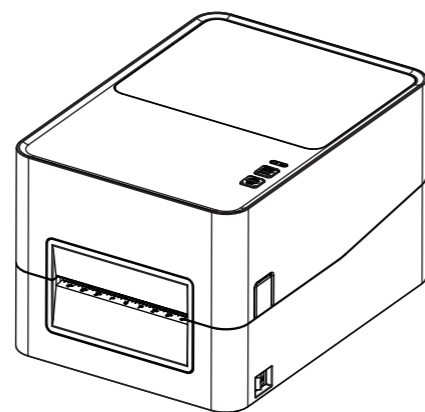

HT400

Manufacturer: Xiamen Hanin Co.,Ltd.
Address: No.96, Rongyuan Road, Tong'an District, Xiamen, Fujian, China 361100
E-mail: support@hpert.com
Web: www.hpert.com

Packing List

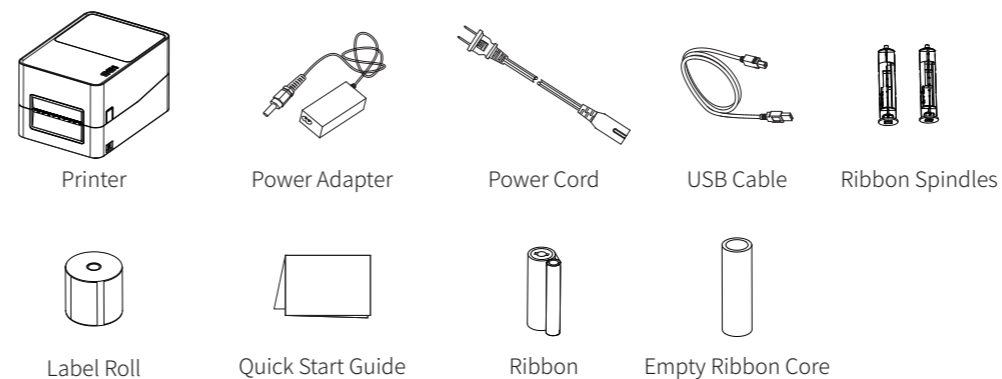

Note: The packing items are based on the order.

Appearance and Components

Front View

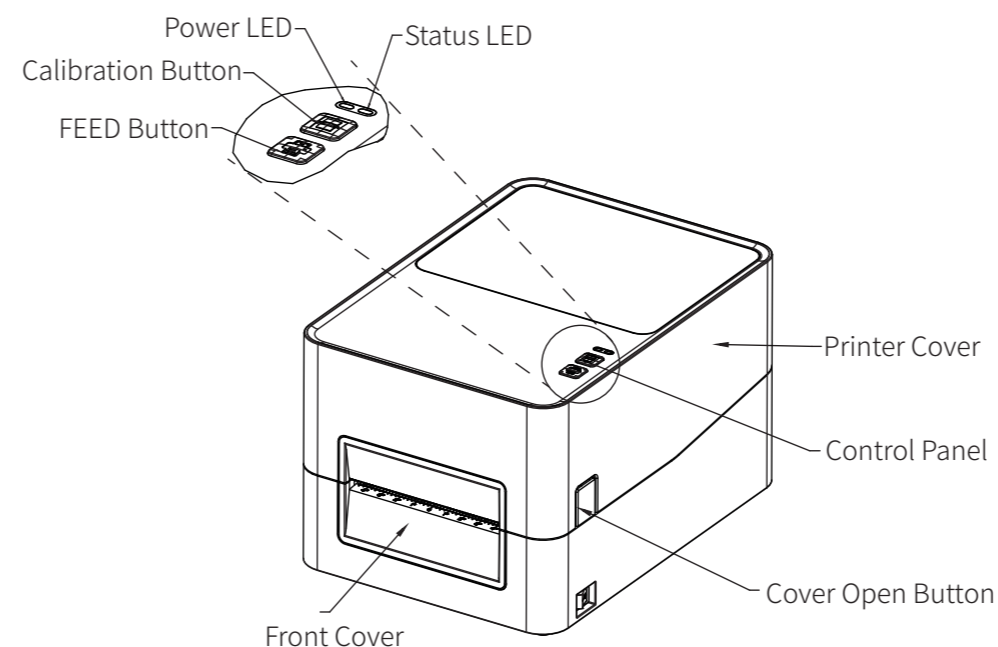

Appearance and Components

Rear View

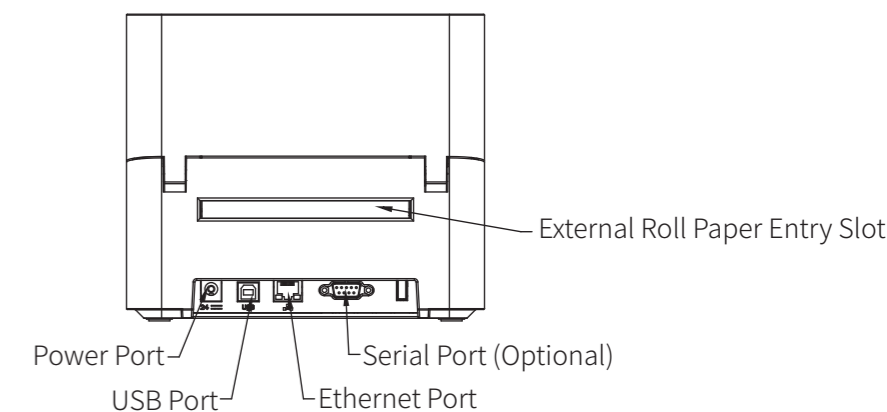

Inside View

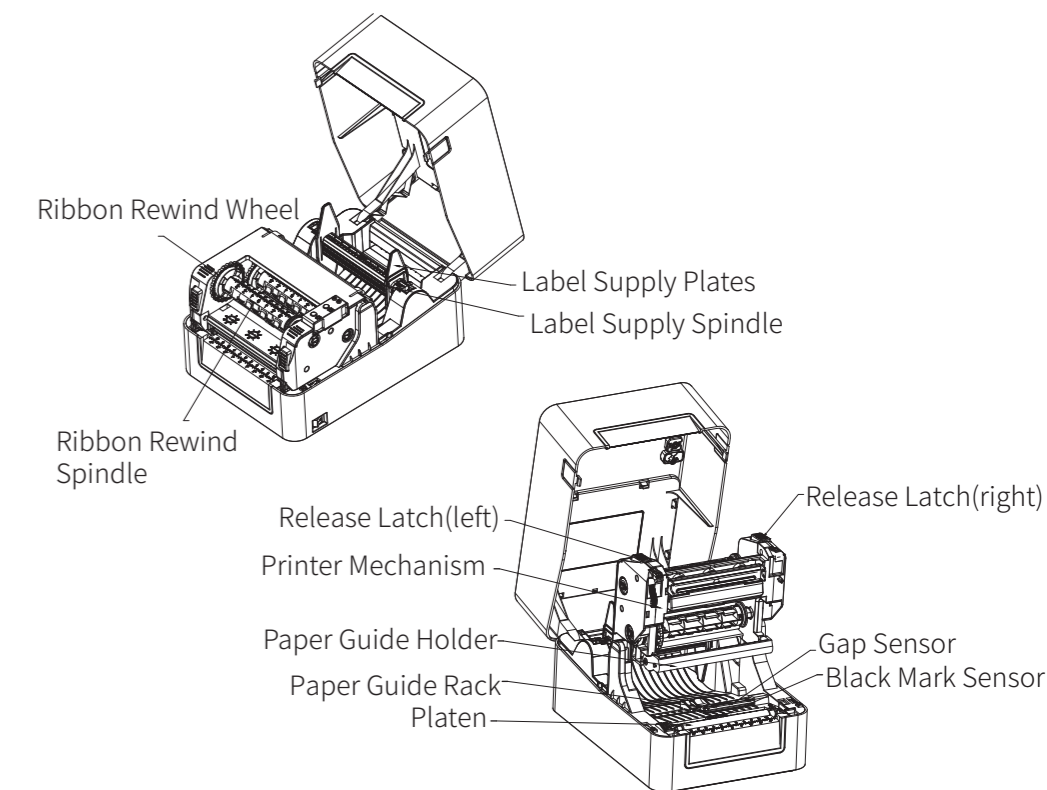

Note: The views above are for your reference. Ports vary by your choice.

Opening the Print Cover

Press and lift the printer cover.

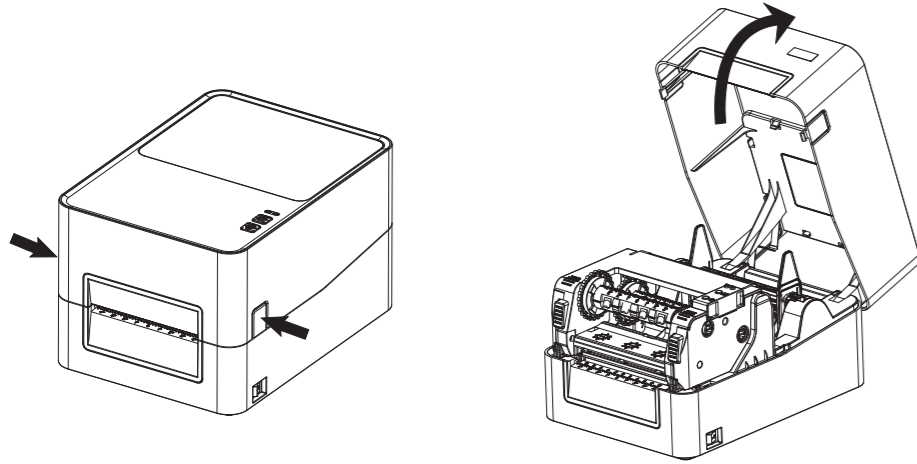

Opening the Printer Mechanism

Release and lift the printer mechanism.

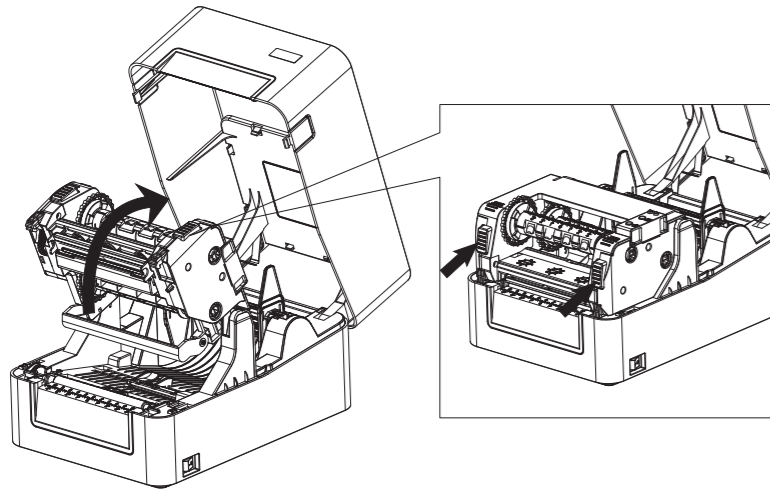

Loading the Roll

1. Put the roll into label supply spindle and then put the roll module into the printer.

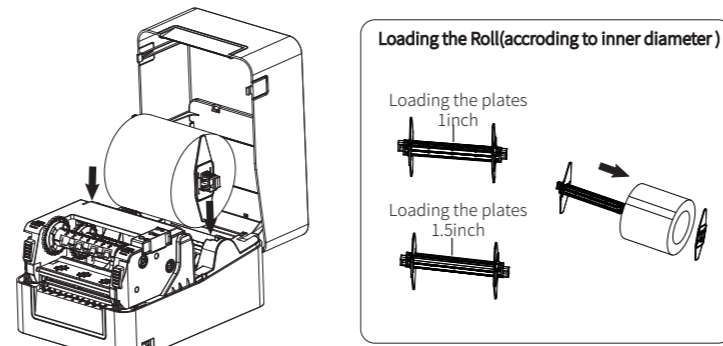

2. Release and lift the printer mechanism. Then pass the labels through label guides and adjust label guides to label's width.

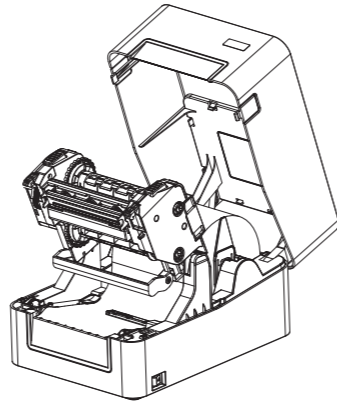

Loading the Ribbon

1. After putting the ribbon into spindle, insert the right part of supply module into supply wheel, and then insert the left part into the groove below.

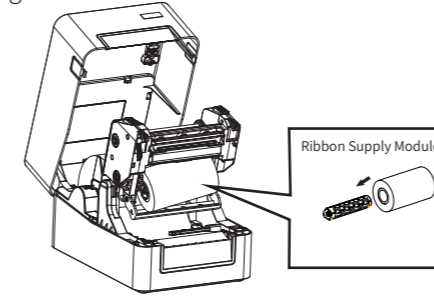

3. Pull up the ribbon and stick it to the empty ribbon core. Wind the core 2~3 circles until the ribbon is pulled tightly.

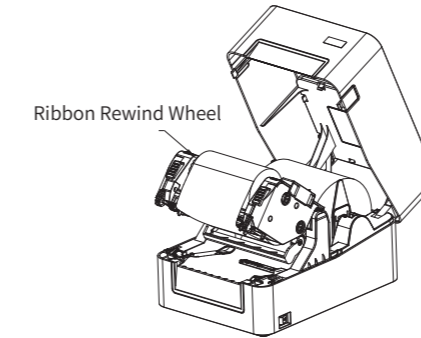

2. After putting empty ribbon core into spindle, insert the right part of rewind module into rewind wheel, and then insert the left part into the groove above.

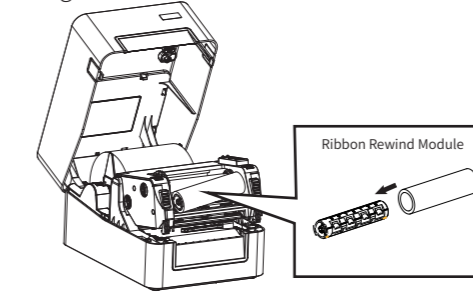

4. Fix the mechanism and then close the cover.

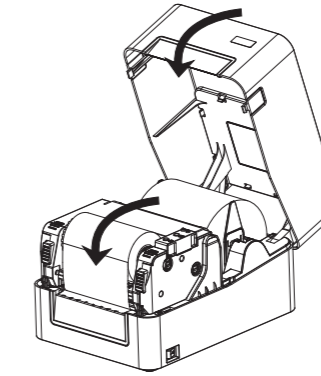

Connecting the Power and USB

1. Make sure the printer's power switch is in the off position.
2. Connect the AC adapter to power receptacle.
3. Connect the power cord to AC adapter.
4. Connect the other end of power cord to the outlet.

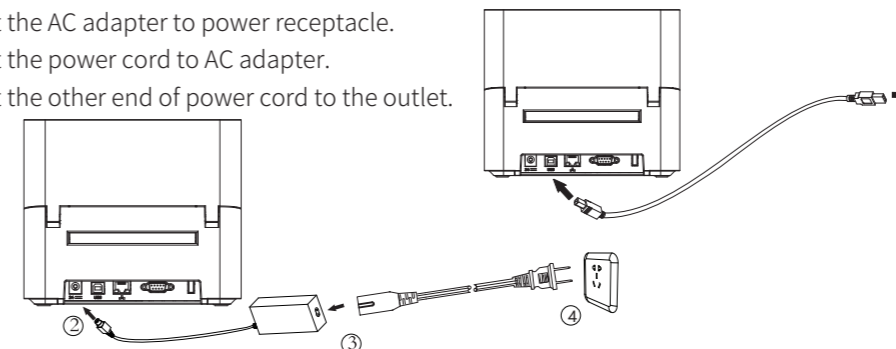

Note: Please refer to windows driver installation in *HT400 User Manual*.



Caution:
This is a Class A product. In a domestic environment this product may cause radio interference in which the user may be required to take adequate measures.